

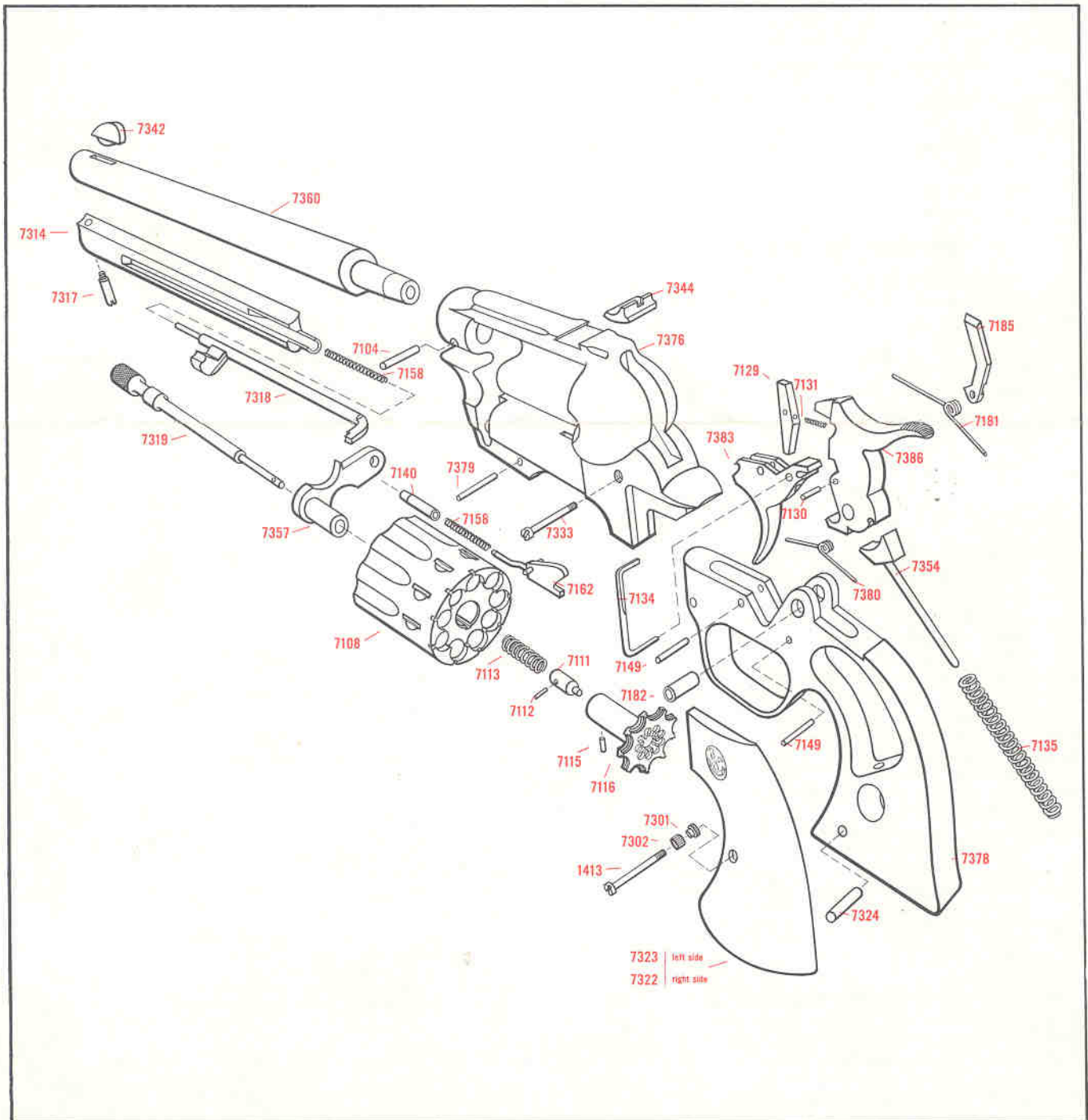

HI-STANDARD REVOLVER WESTERN-STYLE

PARTS PRICE LIST - .22 CALIBER MODEL W-100 "DOUBLE-NINE"

NUMBERS ARE ONLY FOR BLUED GUNS — SEE PARTS LIST FOR DELUXE NICKEL



THE HIGH STANDARD MANUFACTURING CORPORATION

HAMDEN • CONNECTICUT

HI-STANDARD

.22 CALIBER DOUBLE- AND SINGLE- ACTION REVOLVER

PARTS LIST AND PRICES

(Prices Subject to Change Without Notice)

"DOUBLE-NINE"

MODELS W-100 BLUED AND DELUXE NICKEL

HOW TO ORDER REPAIR PARTS

The following information must be furnished when ordering replacement parts:

1. Model Name and Series Number (W-100)
2. Serial Number
3. Number and Name of Parts
4. Color

MINIMUM ORDER \$1.00

Unless advance payment is made, a minimum charge of \$1.00 is made on all orders where the normal cost would be less than \$1.00. Please note also the following paragraph.

PAYMENT

All parts shipments will be made by Parcel Post C.O.D. unless advance remittance is made. PLEASE DO NOT SEND CASH OR STAMPS. Checks, Money Orders, or Drafts are acceptable and will save you C.O.D. charges.

MODEL W-100

Part Number	Part Name	Price Each
Parts Marked With an Asterisk (*) Must Be Fitted at the Factory		
*7360	Barrel (5½") Blue, (Without Sight)	\$ 7.00
*7460	Barrel (5½") DeLuxe Nickel, (Without Sight)	8.00
*7393	Barrel & Front Sight Assembly, Blue (Includes Barrel #7360, Front Sight #7342)	7.50
*7493	Barrel & Front Sight Assembly, DeLuxe Nickel (Includes Barrel #7460 & Front Sight #7342)	8.50
7104	Barrel Pin, Blue	.25
7196	Barrel Pin, DeLuxe Nickel	.35
7357	Crane Assembly, Blue (Includes Crane Link #7305, Crane Link Bearing #7107)	2.75
7457	Crane Assembly, DeLuxe Nickel (Includes Crane Link #7405, Crane Link Bearing #7107)	3.50
*7108	Cylinder, Blue, DeLuxe Nickel (Not Sold Separately. See Cylinder Assembly #7156)	
*7156	Cylinder Assembly, Blue (Includes Ejector Assembly #7161, consisting of Ejector #7116, Ejector Alignment Dowel #7117, Ejector Rod #7319, Crane Link #7305)	13.00
*7156	Cylinder Assembly, DeLuxe Nickel (Includes Ejector Assembly #7161, consisting of Ejector #7116, Ejector Alignment Dowel #7117, Ejector Rod #7419, Crane Link #7405)	15.00
7111	Cylinder Lock Plunger, Blue, DeLuxe Nickel	.60
7112	Cylinder Lock Plunger Pin, Blue, DeLuxe Nickel	.25
7113	Cylinder Lock Plunger Spring, Blue, DeLuxe Nickel	.25
7162	Cylinder Stop Assembly, Blue, DeLuxe Nickel (Includes Cylinder Stop #7114, Cylinder Stop Cross Pin #7115)	1.65
7158	Cylinder Stop Spring, Blue, DeLuxe Nickel	.25

FACTORY SERVICE

If parts are to be fitted at the factory, send revolver marked for the attention of our SERVICE DEPARTMENT, furnishing complete and specific repair instructions. A cost estimate of the parts and labor charges will be immediately sent for your approval before work is started.

Unless a flat rate charge is specified, a MINIMUM of \$5.00 will be charged on servicing revolver at the factory.

REVOLVER SHIPPING INSTRUCTIONS

BONAFIDE DEALERS IN FIREARMS are permitted by postal regulations to send revolvers to the factory by Parcel Post. INDIVIDUALS are not permitted to mail firearms and we recommend shipment by railway express.

All shipments to factory must be prepaid.

MODEL W-100

Part Number	Part Name	Price Each
*7116	Ejector, Blue, DeLuxe Nickel (Not Sold Separately. See Cylinder Assembly #7156)	
7117	Ejector Alignment Dowel, Blue, DeLuxe Nickel	.25
7314	Ejector Latch Housing, Blue	3.00
7414	Ejector Latch Housing, DeLuxe Nickel	4.00
7317	Ejector Latch Housing Screw, Blue	.25
7417	Ejector Latch Housing Screw, DeLuxe Nickel	.25
7315	Ejector Latch Rod, Blue	.80
7415	Ejector Latch Rod, DeLuxe Nickel	1.00
*7318	Ejector Latch Rod Assembly, Blue (Includes Ejector Latch Thumb Piece #7316, Ejector Latch Rod #7315)	2.20
*7418	Ejector Latch Rod Assembly, DeLuxe Nickel (Includes Ejector Latch Thumb Piece #7316, Ejector Latch Rod #7415)	2.50
7158	Ejector Latch Rod Spring, Blue, DeLuxe Nickel	.30
7302	Escutcheon, Blue, DeLuxe Nickel	.15
7301	Escutcheon Nut, Blue, DeLuxe Nickel	.25
*7376	Frame, Blue (Not Sold Separately)	
*7476	Frame, DeLuxe Nickel (Not Sold Separately)	
7322	Grip, R.H., Blue, Dull Ivory Bone Plastic	1.50
7323	Grip, L.H., Blue, Dull Ivory Bone Plastic	1.50
7325	Grip, R.H., DeLuxe Nickel, Dull Black Plastic	1.50
7326	Grip, L.H., DeLuxe Nickel, Dull Black Plastic	1.50
7311	Grip Assembly, R.H., Blue (Includes Medallion 10355, Escutcheon Nut 7301)	1.75
7312	Grip Assembly, L.H., Blue (Includes Medallion 10355, Escutcheon 7302)	1.75
7327	Grip Assembly, R.H., DeLuxe Nickel (Includes Medallion 10356, Escutcheon Nut 7301)	1.75

CAUTION: FOR SAFETY'S SAKE DO NOT ATTEMPT TO REPAIR REVOLVER WITHOUT RECEIVING RELIABLE

MODEL W-100

Part Number	Part Name	Price Each
7328	Grip Assembly, L.H., DeLuxe Nickel (Includes Medallion 10356, Escutcheon 7302)	1.75
1413	Grip Screw	.25
7324	Grip Alignment Pin	.25
7386	Hammer, Blue, DeLuxe Nickel	4.00
7388	Hammer Assembly, Blue, DeLuxe Nickel (Includes Hammer #7386, Hammer Pawl #7129, Pin #7130, Spring #7131)	5.00
7129	Hammer Pawl, Blue, DeLuxe Nickel	1.10
7130	Hammer Pawl Pin, Blue, DeLuxe Nickel	.25
7131	Hammer Pawl Spring, Blue, DeLuxe Nickel	.25
7333	Hammer Pivot Screw, Blue	.25
7433	Hammer Pivot Screw, DeLuxe Nickel	.25
7134	Hammer Safety Stop, Blue, DeLuxe Nickel	.25
7182	Hammer Sleeve, Blue, DeLuxe Nickel	.15
7135	Hammer Spring, Blue, DeLuxe Nickel	.25
*7354	Hammer Spring Guide Head Assembly, Blue, DeLuxe Nickel (Includes Hammer Spring Guide Head #7336, Hammer Spring Guide Pin #7137)	1.50

MODEL W-100

Part Number	Part Name	Price Each
*7336	Hammer Spring Guide Head, Blue, DeLuxe Nickel	.60
*7137	Hammer Spring Guide Pin, Blue, DeLuxe Nickel	.25
7185	Hand, Blue, DeLuxe Nickel	1.10
7181	Hand Spring, Blue, DeLuxe Nickel	.25
7140	Link Pivot Pin, Blue, DeLuxe Nickel	.50
10355	Medallion	.60
7342	Sight, Front, Blue, DeLuxe Nickel	1.00
7444	Sight, Rear, Blue, DeLuxe Nickel	1.25
7383	Trigger	2.50
*7378	Trigger Guard, Blue	4.50
*7478	Trigger Guard, DeLuxe Nickel	5.00
7149	Trigger Pivot Pin, Blue, DeLuxe Nickel	.25
7380	Trigger Spring, Blue, DeLuxe Nickel	.25
7149	Trigger Spring Retaining Pin, Blue, DeLuxe Nickel	.25
7379	Trigger Guard Assembly Pin, Blue	.25
7479	Trigger Guard Assembly Pin, DeLuxe Nickel	.25

INSTRUCTIONS FOR OPERATION AND CARE OF YOUR "DOUBLE-NINE" REVOLVER

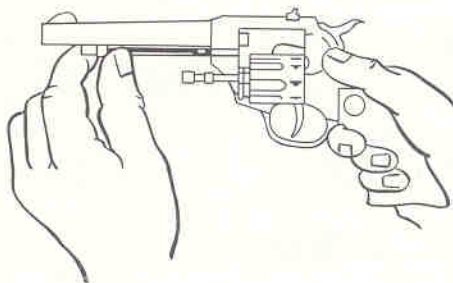

Fig. 1

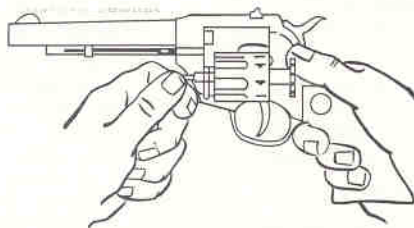
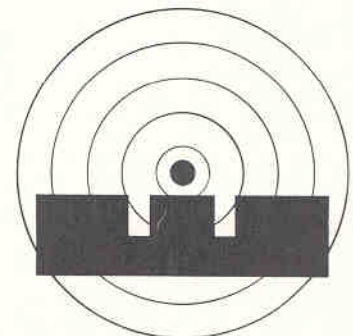

Fig. 2



Correct Sighting

LOADING AND FIRING:

1. Be sure that hammer is forward.
2. Hold Revolver in right hand with index finger of left hand against front of ejector latch housing. With left thumb move ejector latch to extreme forward position and, at the same time, swing out cylinder to left by pressing right index finger against it (See Figure 1). Be sure to release ejector latch.
3. Insert one .22 caliber short, long or long rifle cartridge in each of the nine chambers of the cylinder.
4. Return cylinder to frame by pressing thumb against cylinder. Do not push ejector latch forward when closing cylinder. The revolver is now ready to fire.
5. Revolver may be fired double action merely by squeezing trigger for each shot.
6. Target shooting, or other shooting demanding a maximum of accuracy, is usually done single action. For single-action shooting, pull back hammer to cocked position for each shot.
7. To unload revolver or remove fired cartridge cases, move ejector latch to extreme forward position and at the same time, swing out cylinder to left by pressing right index finger against it (See Figure 1), and push ejector rod to the rear (See Figure 2).
8. Pull ejector rod forward before reloading or attempting to close cylinder.
9. Because cylinder chambers are counterbored, revolver may be "dry-fired" without injury to cylinder.

Double-Nine revolvers are sighted in at a range of 50 feet. If lateral adjustment is desired because of individual preference in sighting or holding, tap the rear sight gently, using a brass or plastic hammer. Move the rear sight in the direction you want the point of impact to move.

ADVICE. WE MAINTAIN A SERVICE DEPARTMENT WHICH WILL PROMPTLY GIVE YOU ADVICE AND SERVICE.

Hi-Standard .22 Caliber Autoloading Pistols

ALL-STEEL FIELD MODELS



Sport-King: Favorite .22 long rifle autoloader boasts remarkable engineering advances and wonder metals for top performance in the field. Ideal handgun for hunters, trappers, campers, fishermen, plinkers, target shooters.

Flite-King: Same outstanding features as Sport-King, but fires thrifty, quiet .22 shorts.



Dura-Matic: The perfect extra gun at a low price. Fires .22 long rifle ammunition with excellent accuracy. Double safety has a visible indicator to show when gun is ready to fire, plus a combination slide lock for positive cross-bolt safety. This versatile 10-shot autoloader fits the need of many shooters who can take pride in its sleek, modern lines.

LIGHTWEIGHT FIELD MODELS



Sport-King Lightweight: High tensile metals used in missiles are crafted into forged-alloy frames for these amazing handguns. Light in weight for easy carrying, you get tremendous durability for a lifetime of shooting fun. Sport-King Lightweight is a ten-shot .22 long rifle autoloader available in blued or Deluxe Nickel finish.



Flite-King Lightweight: Shoots thrifty .22 short ammunition indoors or out with quiet report and target accuracy — otherwise identical to Sport-King Lightweight. Light as a feather but rugged as a rock, it's perfect to pack along on your hunting or fishing trips. For your basement range, the Flite-King offers fun for your family, too!

SUPER-ACCURATE TARGET MODELS

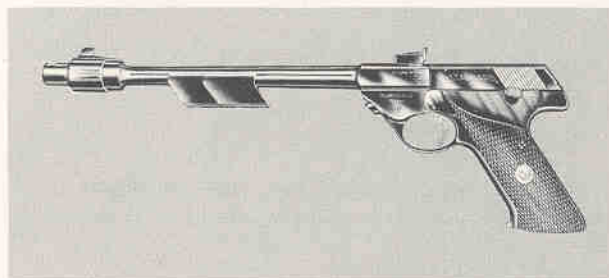

Supermatic Trophy: A possession of pride worthy of the world's greatest champions. Superb hand-finishing inside and out for unexcelled beauty and precision performance. Ten-shot .22 L.R. autoloader has gold trigger and lettering, walnut grips.

Supermatic Citation: All the features of Trophy with Citation-grade finish, laminated grips.

Olympic Citation: .22 short version of this superb target-grade handgun.



Supermatic Tournament: Top value in a medium-priced target pistol. Full measure of Hi-Standard quality with all but a few of the custom extras found in the Trophy. Choice of 4½" or 6¾" heavy, tapered, interchangeable barrels. Double-action safety. Sure-fire magazine. Diamond-checked laminated grips.

PRICES

Steel Sport-King or Flite-King, 4½" or 6¾" barrel, \$46.50, both barrels \$54.50 • Dura-Matic, 4½" or 6¾" barrel, \$39.50, both barrels \$47.00 • Sport-King Lightweight or Flite-King Lightweight, 4½" or 6¾" barrel, \$46.50, both barrels \$54.50 • Sport-King Lightweight Deluxe Nickel, 4½" or 6¾" barrel, \$49.95, both barrels \$58.95 • Supermatic Trophy, 6¾", 8", or 10" barrel, \$110.00 • Supermatic Citation or Olympic Citation, 6¾", 8", or 10" barrel, \$85.00 • Supermatic Tournament, 4½" or 6¾" barrel, \$65.00, both barrels \$75.00.