

AMT Instruction Manual



LIGHTNING

25/.22 AUTO RIFLE



818-

ARCADIA MACHINE & TOOL, INC. — Covina, California 91722 U.S.A.

25 / 22

AMT LIGHTNING

GENERAL FEATURES AND NOMENCLATURE

HEIGHT: 6½"

WEIGHT: 6 LBS.

OVERALL LENGTH: OPEN - 37½" CLOSED 26½"

STATEMENT OF LIABILITY

WARNING:

This rifle is classified as a dangerous weapon and is surrendered by AMT with the understanding that the purchaser assumes all liability resulting from unsafe handling or any action that constitutes a violation of any applicable laws or regulations. AMT shall not be liable for personal injury or loss of property or life resulting from the use of this rifle under any circumstances, including intentional, reckless, negligent or accidental discharge.

Further, AMT will not be liable for any alterations to the rifle or any parts thereof. AMT will not condone or authorize any changes to be made after the rifle has left the factory. If your AMT rifle is in need of service or adjustment, follow the instructions in this manual under the section marked "SERVICE".

Please read the warnings in this manual carefully. Be sure you understand the functions of this rifle before loading and firing it. Carefully read the "SAFETY" section of this manual. Practice safe handling of this rifle until you are thoroughly familiar with it.

PLEASE BE CAREFUL!

6. Moving the safety to the "FIRE" position (red band visible) renders the rifle ready to be fired. Squeezing the trigger fires the round in the chamber, after which it is ejected and another round loaded into the chamber. If you do not intend to fire the next shot immediately, return the safety to the "SAFE" position until you are ready to fire again.

After firing the last shot, the bolt will not stay in the open position. **EXAMINE THE CHAMBER AND BE SURE IT IS EMPTY BY PULLING THE BOLT TO THE REAR POSITION.**

CLEARING A JAM

In the event that a cartridge does not feed into the chamber, (jams), do not force the bolt shut. This may cause the cartridge to fire and injure the shooter or bystanders and damage the rifle. Following is the proper procedure for clearing the jammed rifle.

1. Be sure that the muzzle is pointed in a safe direction.
2. Engage the safety.
3. Carefully remove the magazine.
4. Pull the bolt to its rear-most position and lock it open by pushing up on the bolt lock. Do not look into the ejection port during this operation. If drawing the bolt all the way back does not pull the cartridge along with it, it may be necessary to use a small wood or plastic dowel, sharpened on one end, to gently remove the cartridge from the chamber and ejection port. Do not use a metal tool. This may detonate the cartridge or mar the rifle.
5. Reinsert magazine and repeat the steps necessary to load the chamber and fire.

UNLOADING

After completion of the shooting session, the following procedure should be carried out exactly as described to unload the rifle.

Point the rifle in a safe direction.

1. Engage the safety (red line not visible).
2. Remove magazine.
3. Pull the bolt fully to the rear position, lock it there with the bolt lock.
4. Check the chamber to be certain it is empty.

TAKE DOWN FOR CLEANING

BEFORE YOU START, BE ABSOLUTELY CERTAIN THAT THE RIFLE IS UNLOADED. NEVER WORK ON A LOADED FIREARM!

1. Remove the magazine, pull the bolt fully to the rear position, make sure there is not a cartridge in the chamber, let bolt close.
2. Remove barrel band with 5/32 allen wrench.
3. Remove stock screw (5/32 allen wrench).
4. Move safety to middle position to clear stock, lift barrel and receiver assembly out of stock.
5. Remove trigger guard by removing two pins LR 006. Cleaning of trigger guard assembly can be done without any further disassembly.
6. To remove bolt, remove bolt stop pin LR 007, pull bolt fully to the rear position, lift out bolt (front first) while holding bolt lever to the rear. After removal of bolt, carefully let bolt lever return to the front of the receiver. Remove bolt lever through ejection port. At this point, bolt, bolt lever and receiver can be cleaned.

RE-ASSEMBLY

1. Install bolt lever through ejection port into position, pull fully to the rear, install bolt rear first then push front into place while holding bolt lever to the rear position. After bolt has seated in place, slowly let bolt lever return to the closed position. Install bolt stop pin.
2. Trigger guard can now be installed. Put hammer in a cocked position, make sure ejector is in its proper position (towards front of trigger guard in slot). Install trigger guard, into holes install cross pins LR 006.
3. Install barrel and receiver assembly into stock (rear receiver first) making sure safety is in the middle position to clear stock, tighten stock screw, install barrel band.

CLEANING

Frequency of cleaning depends upon the frequency of use of the rifle. Accumulation of powder fouling and bullet lubricant in the breech and chamber area may effect the functioning of the rifle, causing jamming or misfiring. If either of these conditions develop, clean the rifle before assuming that something is wrong with it.

All areas of the breech, bolt, magazine, chamber and bore should be scrubbed or wiped clean with a cleaning patch wetted with a powder solvent. After all areas have been thoroughly cleaned, wipe again with an oiled cloth.

Though this rifle is made of high-quality stainless steel, a light coating of surface rust may develop over a period of time, especially in areas of high humidity. This is a very thin surface coating and can be removed with a rust preventive solvent and a clean cloth.

SIGHT ADJUSTMENTS AND SCOPE MOUNTING

Your AMT LIGHTNING RIFLE has been equipped with both open sights and grooves for mounting a 'scope sight. The adjustable rear sight (optional) is provided with elevation and windage adjustments. The adjustment screws should be turned to move the sight blade in the direction that you wish the bullet to strike. For example, turning the windage adjustment screw clockwise moves the sight blade to the left and the impact of the bullet to the left.

The fixed sights of the standard model have been set at the factory. However, should your rifle shoot low, the front sight may be reduced in height to zero the rifle with the ammunition that you will be using. Windage adjustments on the standard model may be accomplished by drifting the rear sight in the direction you wish the bullet to strike the target.

The receiver of your AMT LIGHTNING is grooved for tip-off scope mounting rings. These may be purchased from your dealer if you wish to install a scope sight. Follow the installation instructions provided with the mounting rings you purchase.

If it becomes necessary to remove the rear sight, this may be accomplished by carefully tapping the sight out of its dovetail slot. A reference mark on both the sight and receiver will enable you to realign the sights when they are placed back into the dovetail slot.

SERVICE

Prior to shipment, each LIGHTNING RIFLE is carefully inspected and test fired to ensure that it is in proper operating condition. Should the rifle require adjustment, repair or refinishing, we recommend that the rifle be returned directly to the factory SERVICE DEPT. There is no other way to be sure that work is performed in a properly equipped and staffed facility. Failure to use the factory services could result in voiding your warranty.

All rifles returned are to be sent prepaid. All collect shipments will be refused.

For best service, always enclose a cover letter with the rifle furnishing serial number, model of rifle and the nature of the problem or work desired. A statement that the rifle is "defective" is not adequate and will only result in unneeded delays. Try to be as specific as possible.

Federal regulations control the shipment of firearms. It may be impossible for the factory to return a rifle directly to you. Check your local regulations before shipment. If this is the case, we recommend that all firearms be sent through a federally licensed dealer.

Please be sure that both the magazine and the chamber are empty before shipping. Any firearms received in a loaded condition must be reported to federal authorities.

PARTS & ORDERING

All parts orders should be sent to the attention of the Parts Dept., California residents include 6½% sales tax. Minimum parts order is \$1.00.

When ordering parts, specify Model name, Part name and Part number. Also include the complete serial number of the firearm.

*Parts designated by an asterick must be factory fitted. The price shown does not include labor and tax, if applicable. These parts will be replaced on an exchange basis only. The replaced parts will not be returned to you.

If you wish to purchase an extra receiver, you must do so through a federally licensed dealer, as this unit is serialized and classified as a "firearm" by the Federal Government.

25 Round Magazine	\$14.95
50 Round Magazine	\$24.95
Lightning Rifle Case	\$19.95



ARCADIA MACHINE & TOOL, INC.
536 N. Vincent Ave.
Covina, California 91722

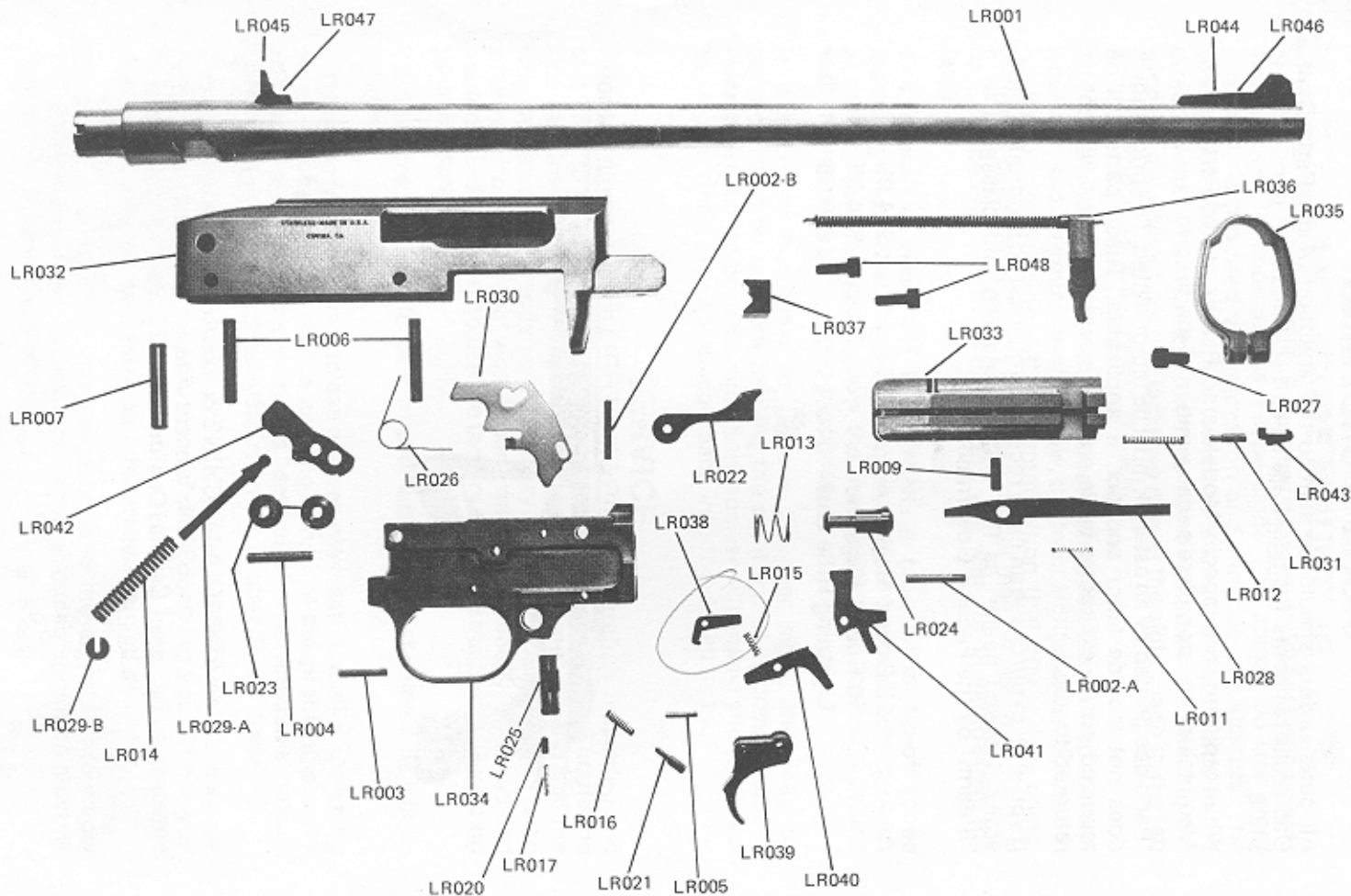

AMT LIGHTNING 25/22 RIFLE PARTS & PRICE LIST

Part No.	Part Name	Retail Price
LR001	Barrel	\$37.95
LR002-A	Magazine Latch Pin	.75
LR002-B	Ejector Pin	.75
LR003	Trigger Pivot Pin	1.00
LR004	Hammer Pivot Pin	1.00
LR005	Disconnecter Pivot Pin	.75
LR006	Trigger Guard Retaining Pin (2)	1.50
LR007	Bolt Stop Pin	.50
LR008	Firing Pin Spring Stop Pin	.50
LR009	Firing Pin Stop Pin	.50
LR010	Recoil Spring Assembly	9.95
LR011	Firing Pin Spring	.50
LR012	Estractor Spring	.50
LR013	Magazine Latch Plunger Spring	1.25
LR014	Hammer Spring	1.00
LR015	Sear Spring	.50
LR016	Trigger Plunger Spring	.75
LR017	Safety Plunger Spring	.50
LR018	**Recoil Rod	
LR019	**Recoil Rod Bushing	
LR020	Safety Plunger	1.00
LR021	Trigger Plunger	1.25
LR022	Ejector	1.50
LR023	Hammer Bushings (2)	3.50
LR024	Magazine Latch Plunger	2.75
LR025	Safety	3.95
LR026	Bolt Lock Spring	1.00
LR027	Barrel Band Screw	.50
LR028	Firing Pin	2.50
LR029-A	Hammer Strut	1.50
LR029-B	Hammer Strut Spring Retainer	.50
LR030	Bolt Lock	2.75
LR031	Extractor Plunger	.75
LR032	*Receiver	89.00
LR033	Bolt	58.50
LR034	Trigger Guard	67.00
LR035	Barrel Band	8.95
LR036	**Bolt Handle	
LR037	Barrel Retainer Block	6.00
LR038	***Disconnecter	5.50
LR039	Trigger	9.95
LR040	***Sear	8.75
LR041	Magazine Latch	8.00
LR042	***Hammer	14.00
LR043	Extractor	1.00
LR044	†Front Site	6.00
LR045	Rear Site	6.00
LR046	Front Site Screw	.50
LR047	Rear Site Screw	.50
LR048	Barrel Retaining Block Screw (2)	1.00
LR049	Stock Assembly	52.00
LR050	Magazine	14.95
LR051	Adjustable Site	25.00

*Sold to FFL Dealers only

**Not Sold Separately

***Must be Installed at Factory

†Specify Bull or Tapered BBI.

WARRANTY STATEMENT

BASED ON MAGNUSON, MOSS WARRANTY ACT, AMT offers no expressed warranty on its product line. AMT does recognize its obligation concerning implied warranty. AMT will continue to stand behind its products as it has in the past. AMT products will be serviced for a period of one year from date of retail purchase, for defects of material or workmanship, at no charge to the purchaser. Be sure to retain your sales slip as proof of purchase date when making a claim.

This instruction manual should always accompany this firearm and be transferred with it upon change of ownership.